

Laton Road, Hastings TN34 2ET

Offers in excess of £195,000



1



1



1



A NEWLY RENOVATED one bedroom apartment with OFF ROAD PARKING and communal gardens situated in a sought after, tree line road within immediate walking distance of Alexandra Park and within easy reach of Hastings Town centre. Accessed via a PRIVATE ENTRANCE the accommodation here is beautifully presented throughout, arranged as a bright living room with a large window framing a view of the COMMUNAL GARDENS, this leads through to the CONTEMPORARY FITTED KITCHEN. The bedroom measures an impressive 16'6 x 13'4 benefitting from a large bay window and there is a LUXURY BATHROOM with a shower over the bath. Externally there are large communal gardens, mostly laid to lawn and at the front of the property there is one allocated parking space. Being sold with a long lease this fantastic property would make the PERFECT FIRST TIME HOME.

GROUND FLOOR
708 sq.ft. (65.7 sq.m.) approx.

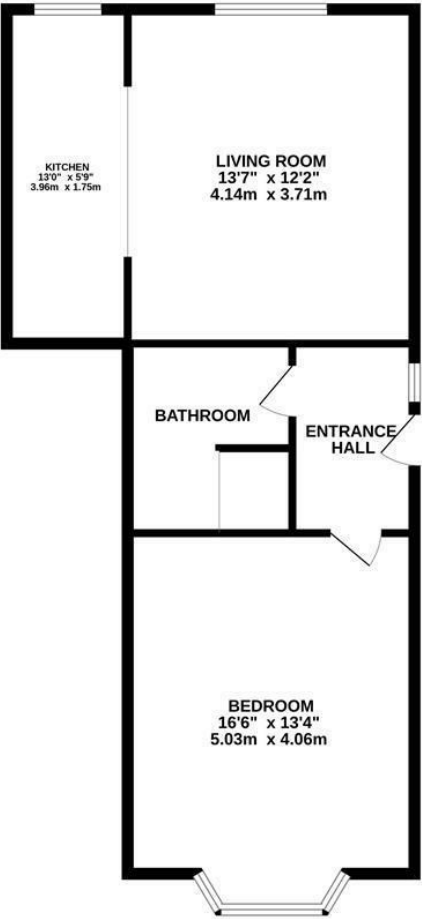

TOTAL FLOOR AREA : 708 sq.ft. (65.7 sq.m.) approx.

Whilst every attempt has been made to ensure the accuracy of the floorplan contained here, measurements of doors, windows, rooms and any other items are approximate and no responsibility is taken for any error, omission or mis-statement. This plan is for illustrative purposes only and should be used as such by any prospective purchaser. The services, systems and appliances shown have not been tested and no guarantee as to their operability or efficiency can be given.
Made with Metropix ©2022

